



# THUMPER FAB

Aluminum Audio Roofs ♦ Roll Cages ♦ UTV Accessories

## CanAm Maverick R 2 Seat Nerf Rails

SKU: TF240701

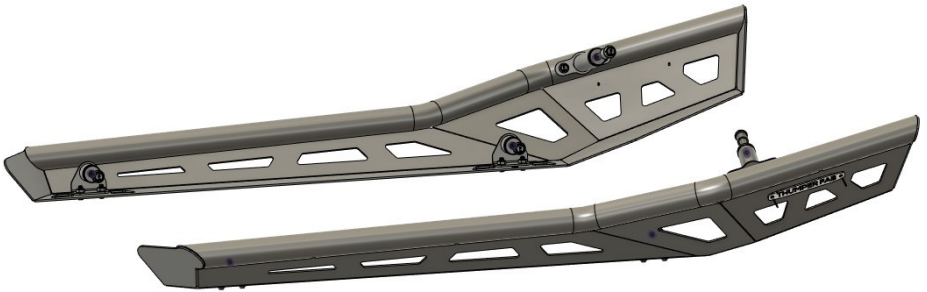

### Thumper Fab

5103 Elysian Fields Rd, Marshall, Tx 75672

Customer Service: 903-472-0928

[www.thumperfab.com](http://www.thumperfab.com)

# CanAm Maverick R

## 2 Seat Nerf Rails



SKU: TF240701

### PARTS

REF	QTY	DESCRIPTION
1	1	Nerf Rail - DRIVER (D)
2	1	Nerf Rail - PASSENGER (P)
3	2	Lower Mount Bracket
4	1	Upper Mount Bracket
HARDWARE		
5	4	M10x65 Flange Bolt 10.9 Yellow Zinc
6	4	M10 Zinc-Plated Steel Split Lock Washer
7	2	Flanged Hex Head, M10 x 1.50mm, 90mm Long
8	8	M8-1.25mm x 20mm Button Head Hex Drive Bolt, Black Zinc Plated
9	4	Hex Flange Bolt, M8-1.25 x 20mm Zinc Finish DIN 6921 Class 8.8
10	12	M8 Zinc-Plated Steel Split Lock Washer
11	2	Spacer

### TOOLS

- 15mm Wrench
- 15mm Socket
- 13mm Wrench
- 13mm Socket
- 5mm Allen

### BEFORE YOU BEGIN

If you do not feel comfortable installing your **Thumper Fab NERF RAILS**, please see your nearest Polaris Dealer for installation.

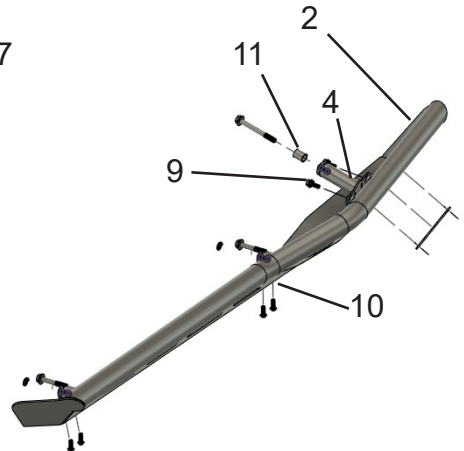
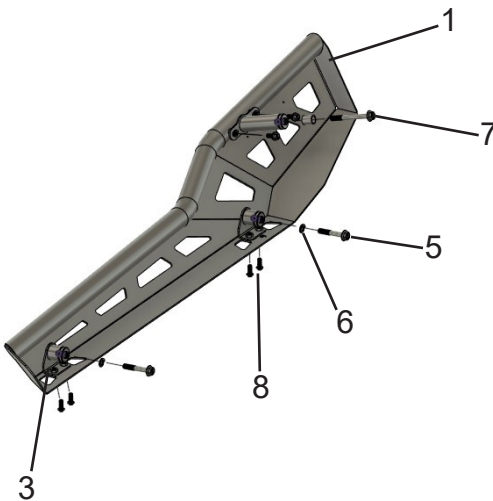

# INSTALLATION INSTRUCTIONS

## Install Upper and Lower Mount Brackets

Before beginning installation process, it is suggested to check each mount bracket (lower and upper) to ensure that the 10mm and 8mm bolts thread into each threaded hole on the mount brackets. Removal of any powder coat build up may be required. This can be done by running a M10x1.5 and a M8x1.25 tap into the threads, or by using a sharp tool or pick to clean the edges of the holes where the threads begin. Begin the installation by locating the (4) Lower Mount Brackets and the (2) Upper Mount Brackets. Starting with the Lower Mount Brackets, loosely fasten them with M10 x 65mm Bolts and M10 Split Washers. (FIG. 3). Place the Lower Mount Bracket into the oem cutouts along the bottom of the rocker panel as shown below. (FIG. 1 & 2) Insert the M10 bolts (with split washers) through the slots in the frame tube and thread them into the Lower Mount Bracket just enough so the most of the slack is taken out, but they can still move. The front-most bracket attachment point can be accessed from underneath the unit, through the skid plate. (FIG. 4) Rear-most lower mount bracket attachment point can be accessed from inside the cab area. (FIG. 5) Removing the seat will make this much easier to install, but is not necessary.



FIG 1



FIG 2



FIG 3

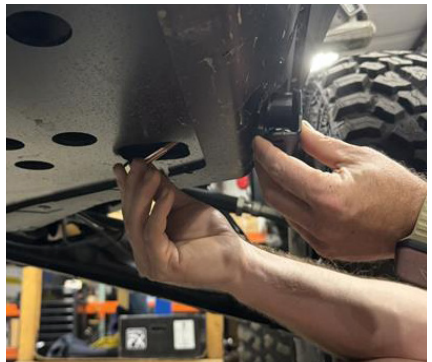

FIG 4

# INSTALLATION INSTRUCTIONS



FIG 5



FIG 6

Next, attach the Upper Mount Bracket to the Nerf Rail. Fasten with (2) M8 Hex Flange Bolts and (2) M8 split washers. Note the direction of mount bracket in photo below. Photo below is a DRIVER side part. The tube on the Upper Mount Bracket should angle towards the rear of the nerf rail/unit. (FIG. 7-9)



FIG 7



FIG 8



FIG 9

# INSTALLATION INSTRUCTIONS

## Install Nerf Rail Assembly

Next, lift the nerf rail up into place. The pre-installed Upper Mount Bracket should be inserted through the plastics, then using the M10 x 90mm bolt with the spacer, insert the bolt through slots in the chassis and thread into the Upper Mount Bracket. (FIG. 10 & 11) Having someone else there to hold the rail up while you fasten the hardware will make thing a lot easier.



FIG 10



FIG 11

Next, using the M8 button head bolts with M8 split washers, insert the bolts up through the bottom face of the nerf rail and thread into the weld nuts on the lower mount brackets. (FIG. 12 & 13) Fasten loosely for now.



FIG 12

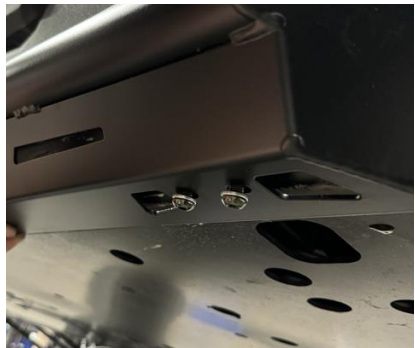

FIG 13

Once all hardware is in place, begin tightening all hardware while making any fine adjustments for placement as you go. Start with fully tightening the M10 hardware that attach the mount brackets to the chassis, then move onto the M8 hardware.



**THUMPER FAB**

**Thumper Fab**

5103 Elysian Fields Rd, Marshall, Tx 75672

Customer Service: 903-472-0928

[www.thumperfab.com](http://www.thumperfab.com)