

Can-Am Commander
Rear Bumper

SKU: TF140601

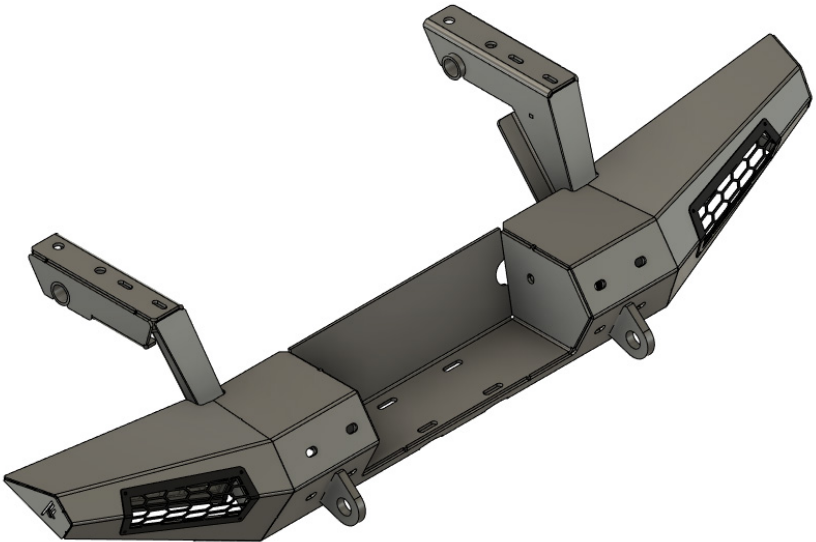

Thumper Fab
5103 Elysian Fields Rd, Marshall, Tx 75672
Customer Service: 903-472-0928

Can-Am Commander

Rear Bumper

SKU: TF140601



PARTS

REF	QTY	DESCRIPTION
1	1	Bumper Main Body
2	1	Driver Side Mount Bracket
3	1	Passenger Side Mount Bracket
4	1	Driver Side Light Cover
5	1	Passenger Side Light Cover
HARDWARE KIT		
A	4	5/16" X 2-3/4" Hex Bolt
B	8	5/16" Flat Washer
C	4	5/16" Nylon Lock Nut
D	10	3/8" x 1" Button Socket Cap Screw
E	10	3/8" Flat Washer
F	10	3/8" Lock Washer
G	10	3/8" Nylon Lock Nut
H	8	8-32 x 1/2" Socket Cap Screw
I	8	8-32 Nylon Lock Nut
J	2	M6 Flange Nuts
K	1	Wiring Harness

TOOLS

- Drill
- 5/16" Drill Bit
- Utility Knife
- Pencil Grinder
- 9/64" Allen Wrench
- 11/32" Wrench
- 7/32" Allen Wrench
- Ratchet
- Extension
- 1/2" Socket
- 1/2" Wrench
- 9/16" Socket
- 15mm Socket

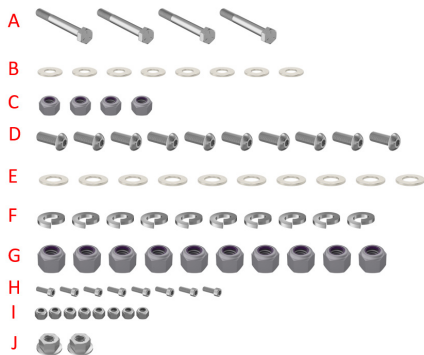

BEFORE YOU BEGIN

If you do not feel comfortable installing your **Thumper Fab** Rear Bumper, please see your nearest Can-Am® Dealer for installation.

INSTALLATION INSTRUCTIONS

Installation Preparation

Remove the tailgate and use the hex holes in the rear bed rails as guides to drill holes through bed from the underside with a 5/16" drill bit to prepare for the 4 x 5/16" x 2-3/4" hex mounting bolts (A) (FIG 1).



FIG 1 - Remove the tail gate and drill holes using a 5/16" drill bit

Using a 15mm socket remove the bed pivot mount brackets hardware and retain hardware as it will be used to mount Thumper Fab bumper mount brackets. Lift up on the bed and slide pivot brackets off the pivot shafts. Remove O-Ring from pivot shaft as well (FIG 2 & FIG 3).



FIG 2 - Use a 15mm Socket to remove OEM Pivot Brackets **FIG 3 - Remove O-Ring from Pivot Shaft**

INSTALLATION INSTRUCTIONS

Installation

Feed the 4 x 5/16" x 2-3/4" hex mounting bolts with 5/16" flat washer (B) through holes drilled into the bed from the top of the bed. You will need to shave down a portion of the bed to have the bolt and washer sit flat to the bed on the front most mounting holes (FIG 4 & FIG 5).



FIG 4 - Place bolts through holes and note area that needs to be shaved



FIG 5 - With surface on bed shaved down, make sure washer sits flat

Lift the bed to allow the bumper mount brackets to slide over the pivot shaft. Once in place, slowly lower the bed and the mounting hardware should slide through the holes provided in mount brackets. (FIG 6).



FIG 6 - Slide Brackets over pivot shaft and lower bed so that mounting bolts slide through mount brackets

INSTALLATION INSTRUCTIONS

Installation

Thread the 4 x OEM flanged lock nuts that were set aside during disassembly onto existing M8 studs coming down from bed. Slide 5/16" washers (B) over 5/16" bolts (A) and thread on locknuts (C), do not tighten (FIG 7).



FIG 7 - Start mounting locknuts on OEM studs and 5/16" bolts that go through bed, Do Not Tighten.

Lift the bed to allow the bumper mount brackets to slide over the pivot shaft. Once in place, slowly lower the bed and the mounting hardware should slide through the holes provided in mount brackets. (FIG 8).



FIG 8 - Slide Brackets over pivot shaft and lower bed so that mounting bolts slide through mount brackets

INSTALLATION INSTRUCTIONS

Installation

With mount brackets loosely fastened to frame, slide the main bumper body over the mount brackets (**FIG 9**).



FIG 9 - Slide the main bumper body over the mount brackets

Fasten the main bumper body to the mount brackets using 10 x 3/8" x 1" button socket cap screws (**D**), 10 x 3/8" lock washers (**F**), 10 x 3/8" flat washers (**E**) and 10 x 3/8" nylon lock nuts (**G**). Once all bolts have been started, tighten the bumper main body to the mount brackets using a 7/32" allen and a 9/16" socket (**FIG 10**).



FIG 10 - Fasten Main Bumper Body to Mount Brackets using 7/32" allen and 9/16" Socket

INSTALLATION INSTRUCTIONS

Installation

With main bumper body mounting bolts tightened, now tighten remaining mounting hardware that fasten mount brackets to the unit using a 15mm socket, 1/2" socket, and 1/2" wrench (**FIG 11**).



FIG 11 - Tighten mount brackets to unit using 1/2" Socket, 1/2" Wrench, and 15mm Socket

Fasten the light covers to the main bumper body using 8 x 8-32 x 1/2" socket cap screw (**H**) and 8-32 nylon lock nuts (**I**) using 11/32" wrench and 9/64" allen wrench (**FIG 12**).

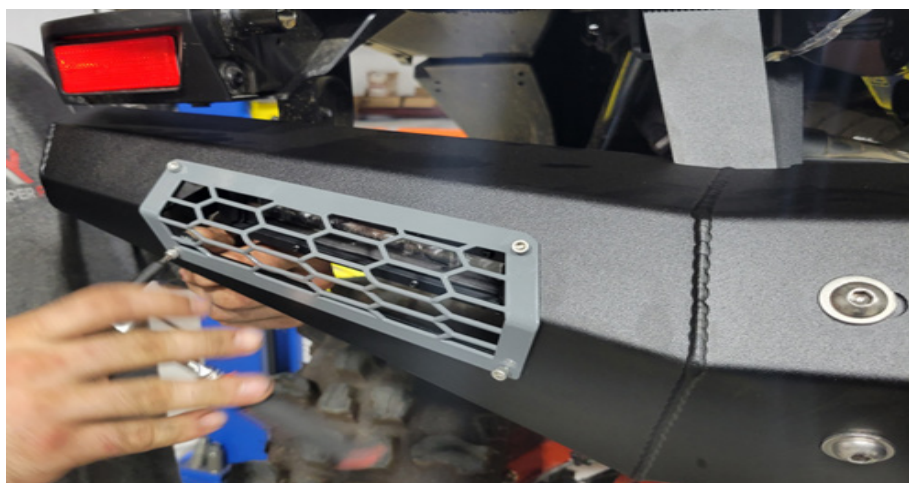

FIG 12 - Fasten Light Covers to Main Bumper Body using 11/32" Wrench and 9/64" Allen

INSTALLATION INSTRUCTIONS

Installation

If optional lights are ordered with the Thumper Fab Bumper Kit, use the provided hardware and tools in the 6" slim light box to fasten the light bars to the light bar tabs provided on the inside of the main bumper body (**FIG 13**).



FIG 13 - Optional: Fasten Light Bars to Main Bumper Body using hardware and tools provided in Light Bar box

INSTALLATION INSTRUCTIONS

PRODUCT DISCLAIMER

The installation of products sold or manufactured by Thumper Fabrication, LLC (Thumper Fab) including, but not limited to suspension components such as lift kits, audio roofs, roll cages, frame stiffener kits, and tires that exceed the original specifications for the vehicle, may change the vehicle's center of gravity and handling characteristics both on- and off-road. You are aware that the installation of tires that are larger than original vehicle specifications may reduce the effectiveness of the braking system. Use of these products may place added stress to the original factory vehicle components which could cause them to weaken or possibly fail.

Products sold or manufactured by Thumper Fab are intended for off-road use only. Operation of a vehicle modified with these products on a road could result in serious bodily injury or death, and such operation may violate the laws of your state or municipality. You agree to operate your vehicle exclusively in the manner intended by the vehicle manufacturer. You agree that failure to safely and reasonably operate your vehicle could result in serious bodily injury or death, and that, as a result of installation of this product(s) to your vehicle, extreme care must be taken to prevent vehicle rollover or loss of control, which may be more likely to occur as a result of said modifications. You will avoid unsafe maneuvers, including sudden sharp turns or other abrupt maneuvers, which could make a vehicular accident more likely. You understand that Thumper Fab is not responsible or liable for any damages or any injuries to yourself or your passengers that could occur upon possible accidents due to driver error, incorrect installations, bad judgment, incompatibility with other aftermarket accessories or natural disasters to the fullest extent allowable by law. You will have all vehicle occupants fasten seatbelts, if equipped, and wear proper safety equipment, such as DOT approved helmet and eye protection prior to operating the vehicle. You understand and acknowledge that failure to wear proper safety equipment may increase the risk of serious bodily injury or death to yourself and any passengers.

Proper installation of products sold or manufactured by Thumper Fab requires knowledge of the factory recommended procedures for removal and installation of original equipment components. Installation of these products without proper knowledge and experience may affect the performance of these components and the safety of the vehicle and cause serious bodily injury or death. It is strongly recommended that a certified mechanic familiar with the installation of similar components perform the product(s) installation.

Prior to installing any products sold or manufactured by Thumper Fab, you will perform or cause to be performed an inspection of their vehicle to confirm its condition is suitable for the installation of these products. A proper inspection of the vehicle includes confirmation that the vehicle has not been in a collision and is free of corrosion. If the vehicle is suspected to have been in a collision or misused, or is otherwise unsuitable for modification, you will not install the product(s). You will continue to inspect the vehicle prior to each use to confirm its condition is suitable for its intended use, and you acknowledge that the failure to do so may result in serious bodily injury or death, as well as damage to the vehicle itself.

You will install any warning labels provided with the product so it may be prominently seen by yourself and all passengers. You will notify all passengers of the modifications performed to your vehicle prior to operation.

Insurance companies may handle coverage of a modified vehicle differently. Please check with your insurance carrier prior to modifying the vehicle to ensure your coverage remains sufficient. Installation of this product(s) may void your vehicle warranty. If this is a concern, please check with the manufacturer or dealer before purchase or installation of this product(s).



THUMPER FAB

Thumper Fab

5103 Elysian Fields Rd, Marshall, Tx 75672
Customer Service: 903-472-0928

www.thumperfab.com