

Ranger XP, 1500, Defender, & CF Moto
Upper Roof Rack OPTION

SKU: TF011912 & TF041904

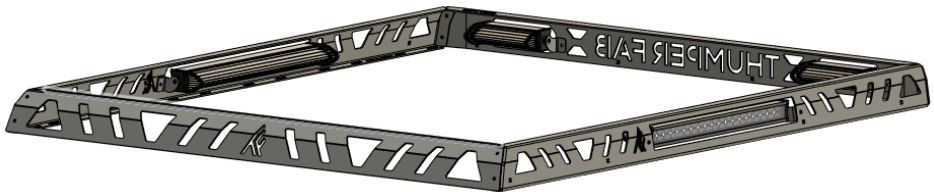
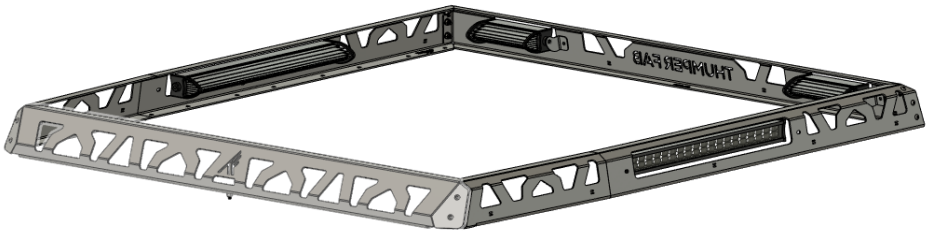

Thumper Fab
5103 Elysian Fields Rd, Marshall, Tx 75672
Customer Service: 903-472-0928

www.thumperfab.com

Ranger XP, 1500, Defender, & CFMoto Upper Roof Rack OPTION



SKU: TF011912 & TF041904

PARTS

REF	QTY	DESCRIPTION
1	1	Side Rail DRIVER
2	1	Side Rail PASSENGER
3	1	Front Rail
4	1	Rear Rail
5	2	20 Inch LED Light Bar
6	2	6 Inch LED Light Bar
	1	20 Inch Light Bar WIRE HARNESS
	1	6 Inch LED Light Bar WIRE HARNESS
HARDWARE		
A	32	M8 Button Head, Hex Drive Screw
B	32	M8 Flanged Head Nylon Insert Locknut
	10	Zip Ties

TOOLS

- 5/32" Allen
- 7/16" Wrench or Socket
- 5mm Allen
- T40 Torx bit

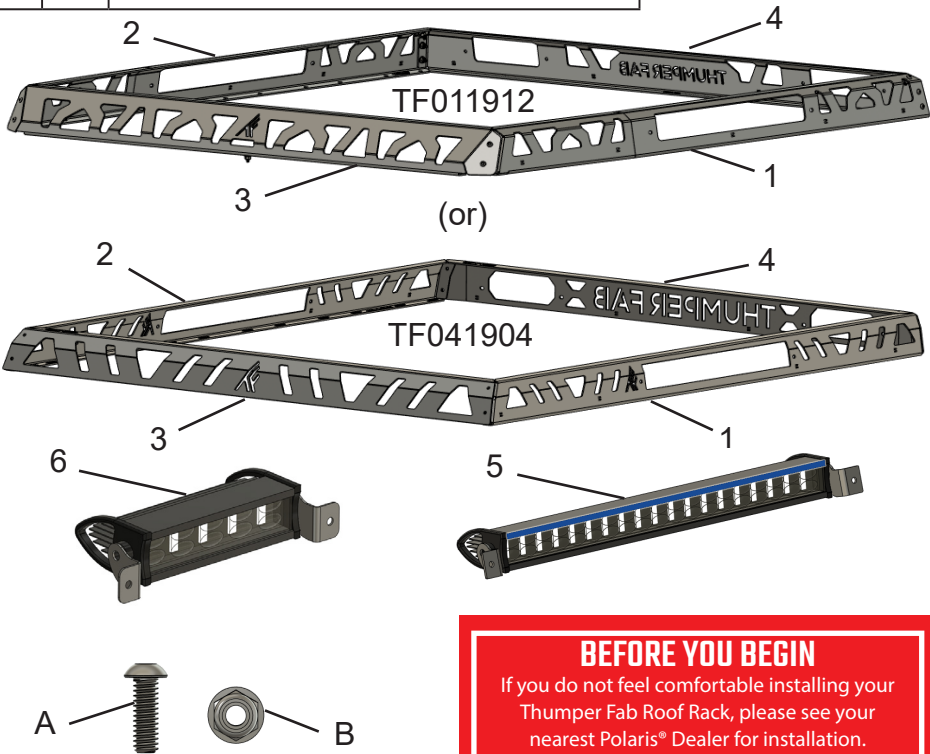

BEFORE YOU BEGIN

If you do not feel comfortable installing your Thumper Fab Roof Rack, please see your nearest Polaris® Dealer for installation.

INSTALLATION INSTRUCTIONS

Pre-assembling the Roof Rack

In order to begin assembling the upper roof rack option onto your roof rack, it is recommended that it be done with the roof rack off of the unit and either on the floor or table. If you have previously purchased the roof rack and have now purchased the upper roof rack option, you will need to remove the hardware that fastens the cross rails onto the roof rack. The upper roof rack Side Rails will be fastened underneath the cross rails.

With the roof rack off of the unit, begin by laying out the side rails. Place the upper roof rack side rails (driver and passenger) on top of the main roof rack side rails. Then place the cross rails on top of the upper roof rack side rails, align the mount hole in all 3 components, and then fasten with the 1/4"-20 hardware. Leave slightly loose for now.



Next, start fastening the front and rear rails onto the upper roof rack with more of the provided 1/4"-20 hardware, as shown below.

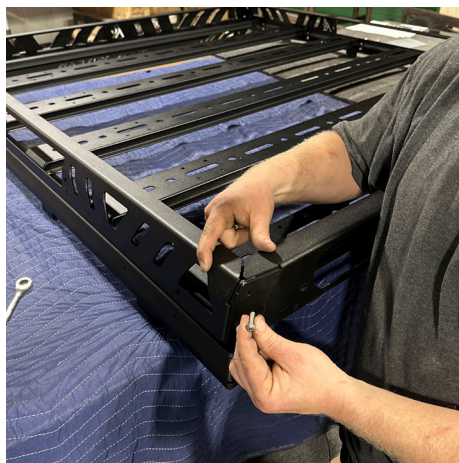

INSTALLATION INSTRUCTIONS

Next, begin installing the light bars into the upper roof rack. First, pre-assemble the light bars with their provided brackets and M8 Socket Hex-Drive Cap screws as shown.

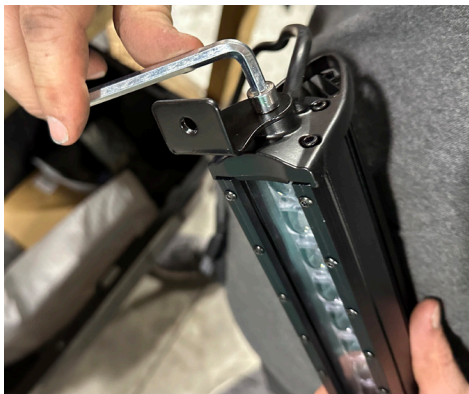

Next, place the 6 inch light bars (2) into the rear rail and both of the 20 inch light bars into the side rails as shown below. Use more of the 1/4"-20 hardware in the kit.



INSTALLATION INSTRUCTIONS

Installing Roof Rack onto the Unit

After the Upper Roof Rack has been installed, go back and make sure all hardware is tight and that any desired adjustments have been made to the light bars. Then see the roof rack instructions on how to install the entire assembly onto your unit.

Light Bar Wiring

Start by removing the WH-BR-U harness from it's package and plugging in all 4 lights to the male deutsche connectors on the harness. From there, route all of the wires from each light neatly along the rails and towards the C-Pillar of the cage on either the driver or passenger side of the unit. Depending on which unit you have will dictate which side would be the best for routing the wiring to the power supply on your particular unit.

Next, locate the WH-BR harness, remove it from it's packaging and begin routing it from the power supply towards the rear of the unit in order to connect it with the previous harness. The switch should be routed through the firewall and into a spot on the dash of your choosing. Depending on which unit you have will dictate exactly how and where to pass through the firewall and into the center tunnel of the floor boards. Once routed, plug it into the WH-BR-U harness.

Next, plug either the WH-BB or WH-PB pigtail into the end of the WH-BR and connect to the power source. After all harnesses are connected, go back and ensure all wiring is zip tied up neatly.

The general idea is to route all wiring neatly and in a fashion so that it is completely clear of any moving parts, pinch points, and heat sources. Further instructions as far as routing that is specific to your particular unit can be found in the Roof Rack instructions for your particular roof rack.





Thumper Fab

5103 Elysian Fields Rd, Marshall, Tx 75672

Customer Service: 903-472-0928

www.thumperfab.com