

CAN-AM DEFENDER WINCH-READY REAR BUMPER & LIGHT KIT

2016+ CAN-AM DEFENDER, DEFENDER MAX
P/N: TF040601

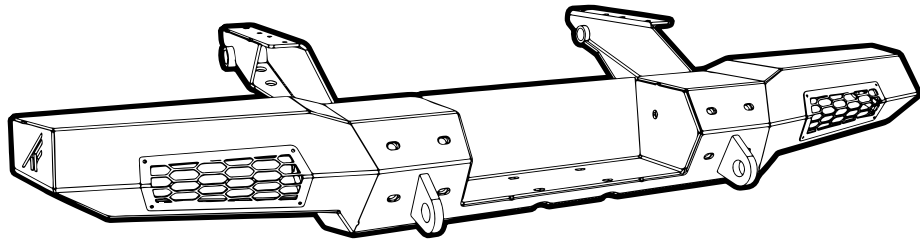

THUMPER FAB

Aluminum Audio Roofs ♦ Bumpers & Roll Cages ♦ UTV Accessories

Thumper Fab

5103 Elysian Fields Rd, Marshall, Tx 75672
Customer Service: 903-472-0928

www.thumperfab.com

CAN-AM DEFENDER WINCH-READY REAR BUMPER & LIGHT KIT

2016+ CAN-AM DEFENDER, DEFENDER MAX
P/N: TF040601



PARTS

REF	QTY	PART DESCRIPTION
1	4	5/16" x 2-3/4 Bolts
2	8	5/16" Flat Washers
3	4	5/16" Nylock Nuts
4	10	3/8" x 1 Button Socket Cap Screws
5	10	3/8" Flat Washers
6	10	3/8" Lock Washers
7	8	#8-32 x 1/2" Hex Socket Cap Screws
8	8	#8 Nylock Nuts
9	2	M6 Flange Nuts
10	1	Wiring Harness

TOOLS

- 5/16" Drill Bit & Drill
- 1/2", 5/16", & 3/8" Socket
- 8/32" Hex Wrench
- Razor Blade

INSTALLATION INSTRUCTIONS

1. Remove the two stock bed mounts and O-rings from each side under bed. Retain hardware.
2. **DRILL 5/16" HOLES** up through bed using first two stock holes specified.
3. With at least one person assisting you, lift or prop the bed so you are able to get the mounting arms in place beneath stock bed mount bolts. Install L & R mounting arms using (2) **5/16" X 2-3/4 BOLTS, WASHERS, & NUTS** in first two holes through bed...
4. ...and **STOCK HARDWARE** from **STEP 1** in third and fourth holes. **Repeat on opposite side.** Tighten when all hardware is in place.
5. ***Loosley*** attach bumper to mounting arms using (4) **3/8" X 1 BUTTON SOCKET CAP SCREWS, FLAT & LOCK-WASHERS** on each side of front face of bumper...
6. ...and (1) **3/8" X 1 BUTTON SOCKET CAP SCREW, FLAT & LOCK WASHERS** on each central inside hole.
7. Tighten all hardware.
8. Install **Light Grills** using **#8-32 x 1/2" SOCKET CAP SCREWS & #8-32 NUTS**.
9. See next page for **WIRING** section.

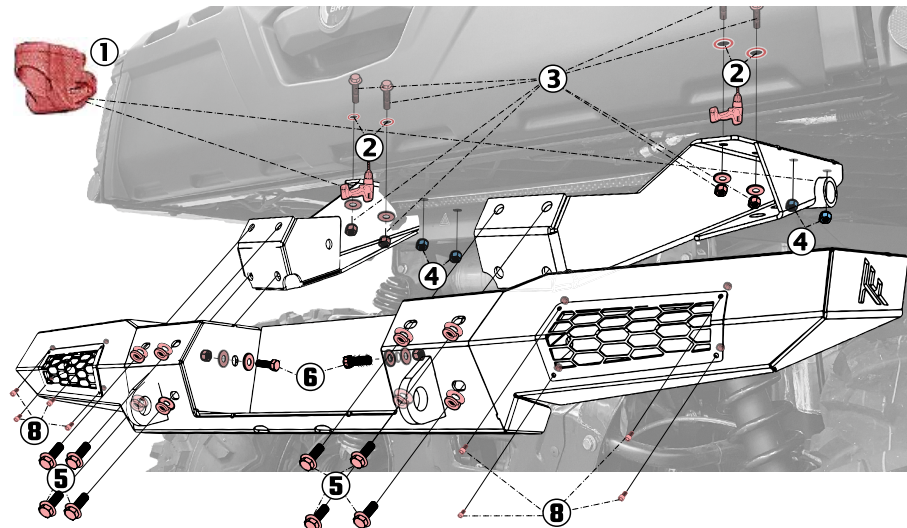

To watch installation video, go to www.thumperfab.com

WIRING INSTRUCTIONS

1. Remove battery access panel by taking off the two twist screws, then pull up and out.
2. Use flathead screwdriver to detach center tunnel panel on floorboard held by (3) push pins.
3. Remove lower firewall access panel held by (8) T20 screws.
4. Pop off switch panel cover by softly prying top, then lifting bottom with flathead screwdriver. Allow panel and assembly to rest loosely on floorboard.
5. Route wiring harness under dash and connect (-) and (+) to bus bar located behind switch panel
6. Route harness to an available pre-cut slot on switch panel and mount switch. Use razor blade to widen pre-cut hole as needed.

7. Connect switch wires as follows:

BLACK → **TOP (10)***
WHITE → **MIDDLE (2)***
BLUE → **BOTTOM (4)***

*Numbers correspond to terminals on switch

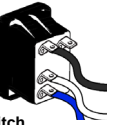

MAKE SURE TO AVOID METAL COOLANT LINES WHEN RUNNING WIRE, AS THEY GET HOT!

8. Run light connector branch of wiring harness along center tunnel and through engine firewall following existing harness.
9. Connect L & R light connectors to lights.
10. Zip-tie to existing harness and vehicle frame as needed to secure.

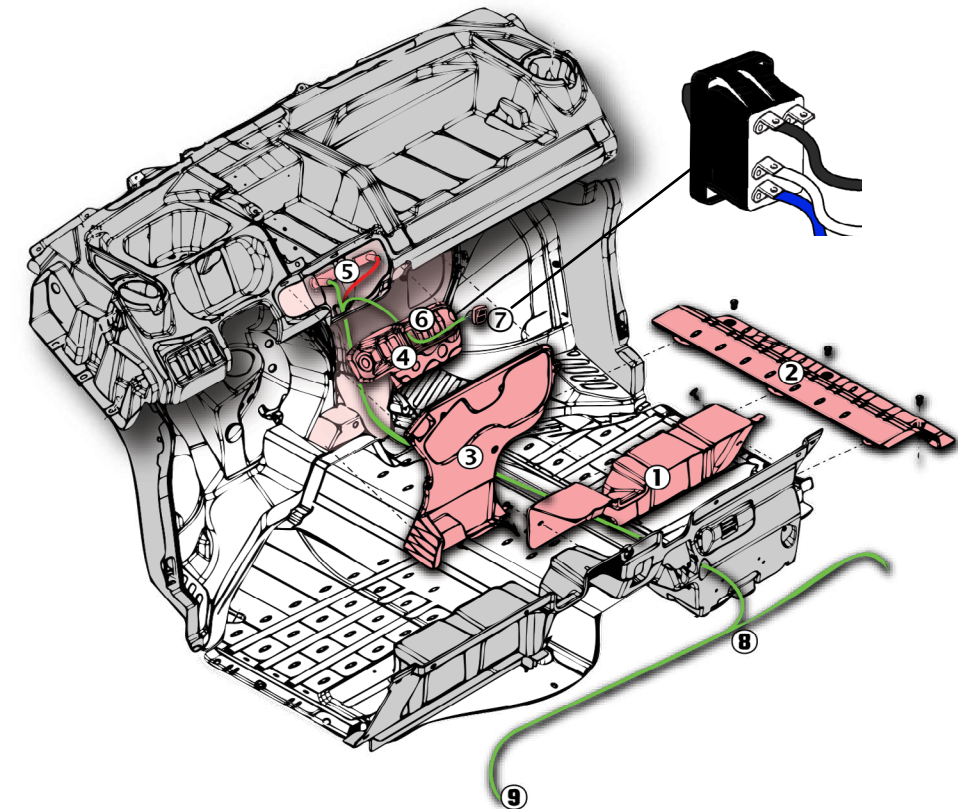

To watch installation video, go to www.thumperfab.com